



# TOWN OF DEER LAKE APPLICATION FOR GENERAL REPAIRS

**Permit expires in 6 months of approval if not picked up.**

|                  |            |                          |  |          |
|------------------|------------|--------------------------|--|----------|
| Owner            |            | Location of Construction |  |          |
| Mailing Address  |            | City/Town                |  | Province |
| Postal Code      |            |                          |  |          |
| Telephone Number | Fax Number | E-mail Address           |  |          |

|                              |                          |
|------------------------------|--------------------------|
| Description of Proposed Work | Construction Value<br>\$ |
|------------------------------|--------------------------|

*Please check which box indicates what you are applying for:*

|                  |             |            |            |               |
|------------------|-------------|------------|------------|---------------|
| Type of Building | Residential | Commercial | Industrial | Institutional |
| Application for  | Renovations | Extension  | Apartment  | Fencing       |
|                  |             |            |            | Sign          |
|                  |             |            |            | Swimming Pool |
|                  |             |            |            | Demolition    |

**If applying for an Extension:**

Measurements of extension

|        |       |        |                 |
|--------|-------|--------|-----------------|
| Length | Width | Height | Exterior Finish |
| m/ft   | m/ft  | m/ft   |                 |

Measurements of existing dwelling

|        |       |        |                 |
|--------|-------|--------|-----------------|
| Length | Width | Height | Exterior Finish |
| m/ft   | m/ft  | m/ft   |                 |

Land size

|          |      |            |           |
|----------|------|------------|-----------|
| Frontage | Rear | Right side | Left side |
| m/ft     | m/ft | m/ft       | m/ft      |

I do solemnly declare that the plans, specifications and statements herein contained in the said application are true and correct to the best of my knowledge.

I understand that the granting of a Permit, the approval of the drawings and specifications, or inspections made by the Municipality, shall not in any way relieve me of full responsibility for carrying out the work or having the work carried out in accordance with the Municipal Building Regulations and the National Building Code of Canada.

The issuance of this permit shall not imply responsibility by the Town of Deer Lake for non-compliance of the applicant to carry out work in accordance with the Municipal Building Regulations and the National Building Code of Canada.

\_\_\_\_\_  
Print Name

\_\_\_\_\_  
Signature

\_\_\_\_\_  
Date



# TOWN OF DEER LAKE APPLICATION FOR GENERAL REPAIRS

**Plot Plan If Extension** (showing distances from dwelling, rear yard, side yard and front yard)

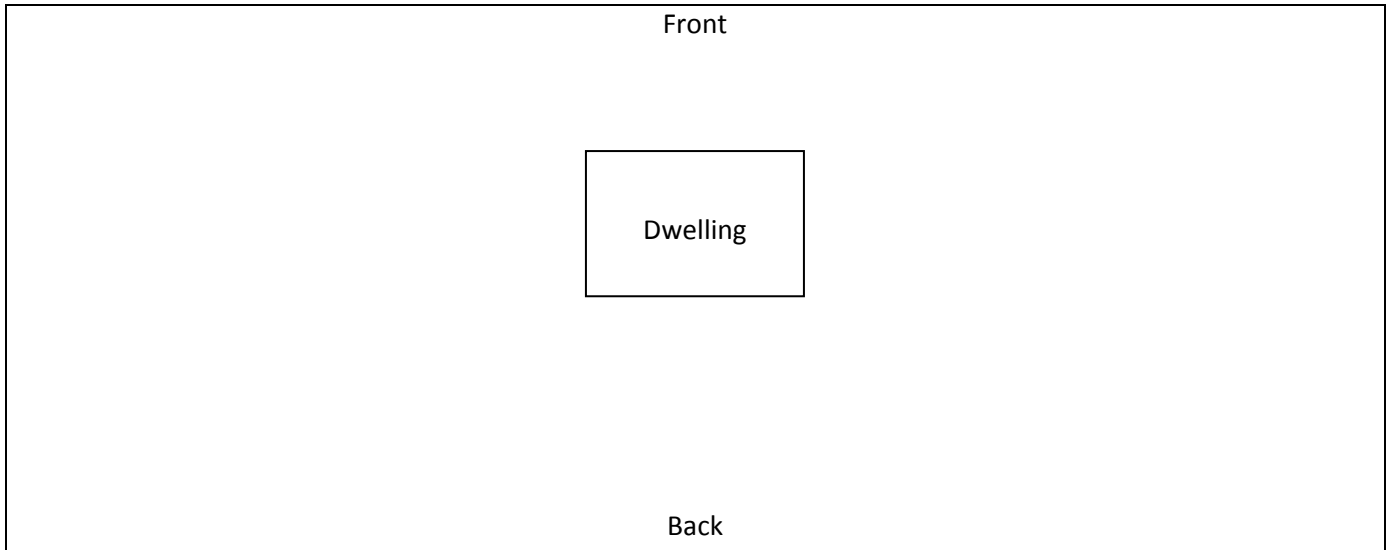

Disclaimer: Information in this document is collected under jurisdiction of the Department of Municipal Affairs. The name and the civic address as well as the development requested will appear on the Town’s Website and will be a part of the public record once tabled at a public meeting of council as authorized in Section 215 (k) of the Municipalities Act, 1999. The Town of Deer Lake and its employees will not be liable for any loss or damages of any nature, direct or indirect, arising from use of the information provided in this document.

## DECKS/PATIOS

- \_\_\_\_\_ shall not extend into the minimum permissible front and side yards
- \_\_\_\_\_ flanking road setback shall not be closer to the rear lot line than 1 meter

- Applications must be submitted at least 7 days prior to Council Meetings, held the 2<sup>nd</sup> and 4<sup>th</sup> Monday of each month.
- Relocation of a building will be treated the same as a new building.
- Applications must state exterior finish of building.
- All permits are subject to a 14 day appeal by any member of the general public.
- Building finishing grade shall be 300 mm above road grade to prevent drainage from the road to the property.
- Applicant/contractor shall confirm location and grade of water/sewer services before construction.

All new construction, renovations, extensions, etc. are subject to supplementary property assessments and taxation. These assessments are often not available until late in the year but are effective from the date of occupancy. The applicant should therefore be aware of and budget for the additional tax.

**STIPULATION:**

When footings have been framed, but before pouring, contact the Town Office (635-2451) so that the site can be inspected to confirm that the building size complies with the Town regulations.

**PERMIT FEE MUST BE PAID UPON RECEIPT OF PERMIT.**

**PERMIT RATES:**

Rates vary depending on the square footage of the building. Please inquire when picking up the permit at the town office - 6 Crescent Street or call (635-2451)

**EXPIRY & RENEWAL**

This permit is valid for 1 year from the date it is issued. It can be renewed should construction not be completed within the year.